

MINOR KTM Micro Rod Series



External connected signal processing,
 Universal joint; Stroke range: 0-400mm,
 Analog output: 0-5V, 0-10V, 4-20mA,
 With 1m shield wire;
 Suitable for narrow space situation.
 Such as plastic injection machine,
 oil cylinder traver controlling etc

KTM Micro Rod Serie	mm	10	15	25	50	75	100	125	150	175	200	225	250	275	300	400
Total Electrical Travel (T.E)	mm	12	17	27	52	77	102	127	152	177	202	227	252	277	302	402
Active Electrical Travel (A.E)	mm	10	15	25	50	75	100	125	150	175	200	225	250	275	300	400
Resistance Range $\pm 20\%$	k Ω	5.0														
Independent Linearity	$\pm \%$	0.05														
Mechanical Travel (M.T)	mm	14	19	29	54	79	104	129	154	179	204	229	254	279	304	404
Output		Voltage Divider														
Resolution		Infinite														
Operating Temperature	C°	-50 + 120														
Dimensions A	mm	53	58	68	93	118	143	168	193	218	243	268	293	318	343	443
Total Dimensions	mm	70	75	85	110	135	160	185	210	235	260	185	310	335	360	460

Dimensions for reference only and subject to change without prior notice.

Mechanical Dimension KTM 尺寸 KTM 微型拉杆式

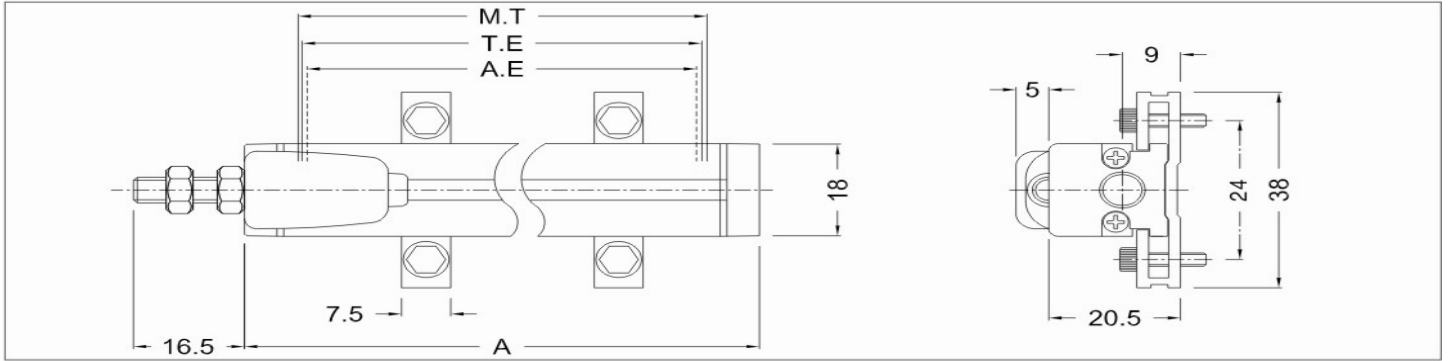

Ball and socket coupling 球窩連軸器

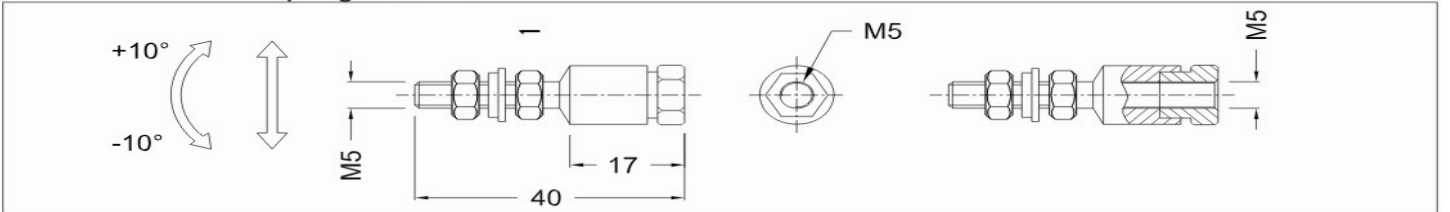

Ball Coupling 球鉸

