

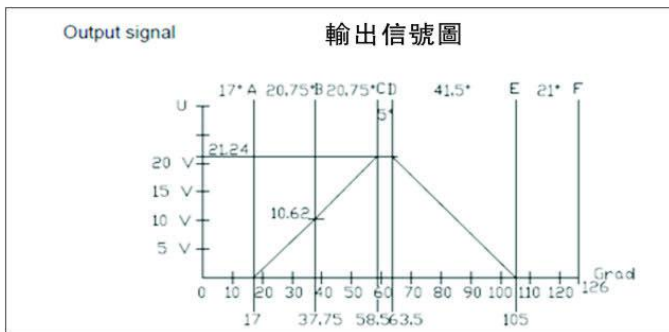

WDA720 角度传感器是专为纺织和印刷机械设计的，产品由导电塑料电阻和多指电刷组成。WDA720 可以提供一个线性度和分辨率良好的电压反馈信号，这个电压信号直接反映角度位置。

WDA720 angle sensor is designed specifically for the textile and printing machinery, products by the resistance of the conductive plastic and multi-referes to brushes composed WDA720 can provide a good linearity and resolution of the voltage feedback signal, the voltage signal is a direct reflection of the angular position.

WDA-720 纺织机械 印刷机械专用电位器

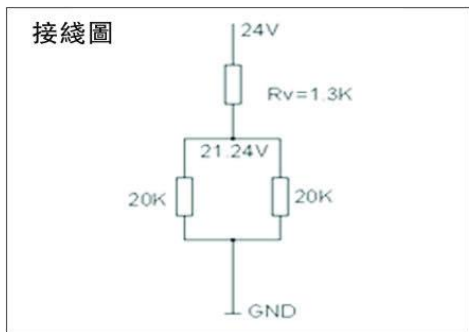

外型尺寸图

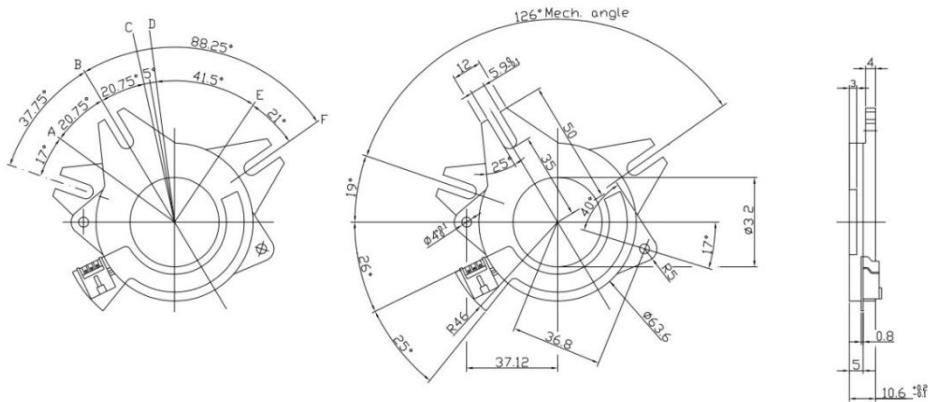

电气特性 Electrical Specifications		机械特性 Mechanical Specifications	
Resistance 电阻	2×10KΩ/2×20KΩ	Rotar number 旋转次数	500,000 cycles
Resistance Error 电阻误差	±20%	Mechanical angle 机械角度	126°
Electrical Angle 电气角度	41.5° +43.5°	Protection class 防护等级	IP50
Independent Linearity 独立线性度	0.5%	Torque 扭矩	typ. 0.7cNm
Power Rating 额定功率	0.5W/Ta40°C		
Recommended Current 推荐电刷电流	<0.1 μA		
Maximum Current 最大工作电流	10mA		
Maximum Resistance of wiper 最大阻值	500		
Insulation resistance 绝缘电阻	10GΩ/500VDC		
Withstand Voltage 耐压	1000VAC/1min		
Temperature Coefficient 温度系数	50ppm/°C		
Voltage Divider T.C. 分压器温漂	10ppm/°C		
环境条件 Enviromental Specification		材料 Materials	
Storage Temperature 存储温度	-40 +105°C	Housing 外壳	Thermoplastic 热塑性塑料
Operating Temperature 工作温度	-25°C +85°C	Rotor 转子	Thermoplastic 热塑性塑料
Climate Type (German Standard) 气候类型	25/085/56	Connector 连接器	3 pins stecker 3口插头
Shock 冲击	50G		
Vibration 振动	10G		